



6014-2Z Deep groove ball bearings

- Popular item
- SKF Explorer

Deep groove ball bearings

Bearing data

[Tolerances](#),

Normal (metric), P6, P5, Normal (inch),

[Radial internal clearance](#),

Matched bearing pairs, Stainless steel
 $d < 10$ mm, Other bearings

Bearing interfaces

[Seat tolerances for standard conditions](#),

[Tolerances and resultant fits](#)

Technical specification

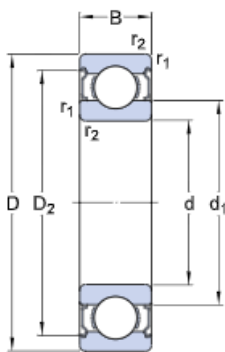

DIMENSIONS

d	70 mm	Bore diameter
D	110 mm	Outside diameter
B	20 mm	Width
d_1	≈ 82.85 mm	Shoulder diameter
D_2	≈ 99.9 mm	Recess diameter
$r_{1,2}$	min. 1.1 mm	Chamfer dimension

ABUTMENT DIMENSIONS

d_{ξ} min.	76 mm	Diameter of shaft abutment
d_{ξ} max.	82.8 mm	Diameter of shaft abutment
D_{ξ} max.	104 mm	Diameter of housing abutment
r_a max.	1 mm	Radius of shaft or housing fillet

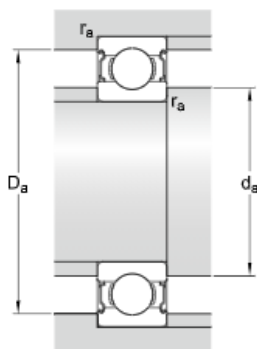

CALCULATION DATA

C	39.7 kN	Basic dynamic load rating
C ₀	31 kN	Basic static load rating
P _u	1.32 kN	Fatigue load limit
	13 000 r/min	Reference speed
	6 300 r/min	Limiting speed
k _r	0.025	Minimum load factor
f ₀	15.6	Calculation factor

MASS

	0.64 kg	Mass bearing
--	---------	--------------

TOLERANCE CLASS

P6		Dimensional tolerances
P6		Radial run-out